



FANQUIP

Hooded Roof Fans Curb Base
Supply or Extract



Call Toll Free: 1300 224 308

Hooded Roof Fans Curb Base

PERFORMANCE DATA

Performance Data	Model No.* (1 Ph/3 Ph)	Fan Diameter mm	Fan Speed rpm	Motor Power kW	Current F.L.A. (1 Ph/3 Ph)	Free Air Delivery l/s
	7-304	300	1440	0.08	1	550
	7-30481/3	300	2880	0.2	1.4/1.1	830
	7-40241/3	400	1440	0.2	1.4/1.1	1480
	7-50161/3	500	960	0.18	1.3/1.0	1629
	7-50241/3	500	1440	0.55	3.3/1.6	2350
	7-60161/3	600	960	0.37	3.0/1.3	3010
	7-60241/3	600	1440	1.1	6.9/3.3	4300
	7-80123	800	720	0.55	2.3	5400
	7-80163	800	960	1.1	3.4	6800
	7-10123	1000	720	1.5	5.5	9800
	7-12123	1200	480	2.0	7.0	14000

*Last digit of Model Number denotes electrical supply: **1** 240V/1Ph/50Hz **2** 415V/3Ph/50Hz

*Noise level is indicative and should only be used to indicate relative figures as actual figures depend on the situation of the fan and relevant field conditions.

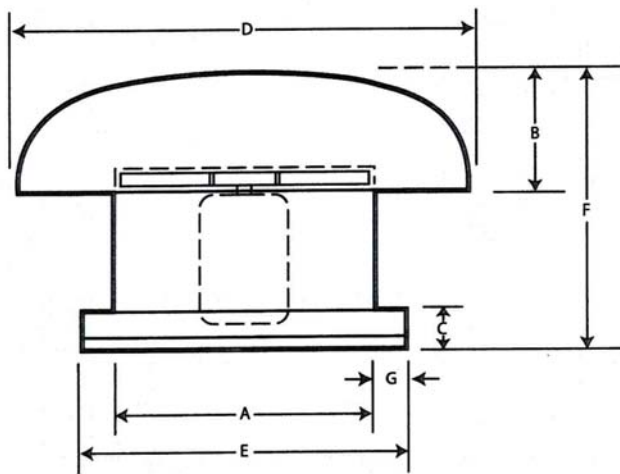

Underside view showing hood supports and birdmesh.

DIMENSIONS

Fan Diameter mm	A mm	B mm	C mm	D mm	E mm	F mm	G mm	Hood No.
300	305	120	60	420	430	280	30	1
400	410	180	60	730	540	430	35	2
500	510	230	75	940	650	480	35	3
600	610	230	75	940	760	480	35	3
800	810	400	75	1000	1060	650	120	4
1000	1015	520	80	1250	1260	730	120	5
1200	1220	540	100	1500	1460	920	115	6

ROOF FAN INSTALLATION GUIDE

Step 1

Identify roof pitch, purlin spacing, roof profile (corrugated iron, trimdeck, etc), and long distance of fan installation point to ridge cap. Ready-to-fit upstands available from Fanquip.

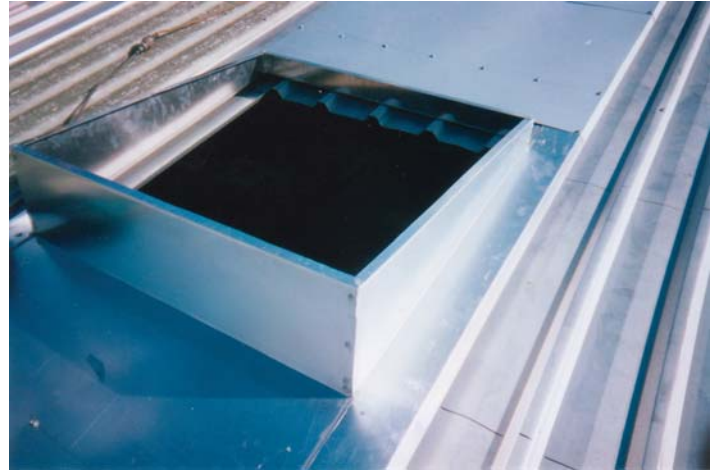

Step 2

Mark and cut opening through roof sheets - between purlins if possible. If purlin spaces are smaller than upstand, cut opening directly over a purlin. Ensure that upper and lower side of upstand is supported by purlins. Sit upstand directly over opening. Fasten into roof sheeting *and purlins* with suitable roof fasteners.

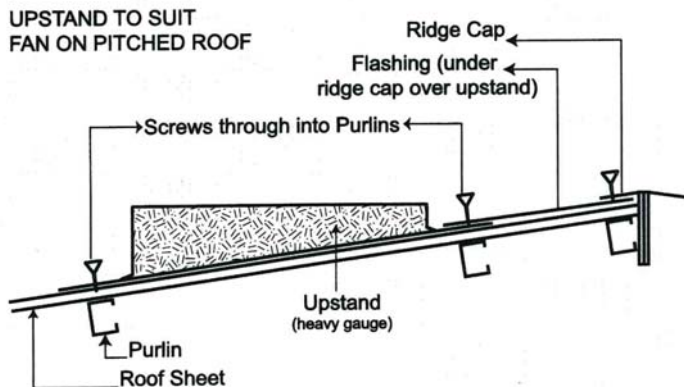

Step 3

Run full width flashing from upper side of upstand to underneath the ridgecap and screw down securely.

Sit the fan on top of upstand and fasten fan base to upstand.





Hooded Roof Fans Curb Base

Introduction

Fanquip Hooded Roof Fans are a high quality roof mounted fan. They are manufactured in Australia to withstand the wide range of climatic conditions found countrywide. They can be used to supply air or as extraction fans.

General Description

The fan base is made from fully welded aluminium to give superior strength and durability. The aerofoil impeller has up to 12 adjustable pitch blades for maximum performance. It is directly driven by a continuously rated motor bolted to a platform welded within the fan cylinder. The weatherproof fibreglass dome is shaped to entirely cover the fan outlet while offering the least resistance to flow. A heavy duty plastic mesh around the inlet/outlet gap protects against ingress of birds.

Options:

Motors can be rated for hazardous locations (i.e. flameproof Ex(e) or Ex(d), or corrosive/wet conditions (hoseproof IP-56). Fan bases can be galvanised steel or fibreglass. Alternatively the motor can be mounted out of the airstream (belt drive). Finish can be powdercoated to clients' colour of choice. Being Australian made ensures all components are available at short notice.

Applications

Fanquip's Hooded Roof Fans are used extensively in industries Australia wide. They have come to be known for their ability to operate in demanding conditions. They are primarily used to extract dust, heat, fumes and stale air from factories, process areas, plant rooms and large commercial buildings.

Technical Advice

Industrial Fan Equipment Pty Ltd (Fanquip) has technical consultants available to give advice on the correct choice of Hooded Roof Fans for you needs.

Operation Maintenance

The procedures as outlined in Fanquip installation, operation and maintenance instructions (separate leaflet), should be followed to ensure satisfactory performance and service life.

Warranty

Twelve months guarantee on mechanical and electrical componentry subject to satisfactory maintenance with assessment and rectification, if any, to take place after return by customer to Fanquip's workshop, or by Fanquip approval on site.

