



FANQUIP

Wall Plate Exhaust Fans

Heavy Duty, Light Weight



Call Toll Free: 1300 224 308



Wall Plate Exhaust Fans



← **Outlet Side**
Showing discharge cowls.

Inlet Side →
Showing mounting off purlins.



Performance Data	Model Number	Fan Diameter mm	Motor Speed r/s	Motor Power kW	Noise dBA at 3m	F.L.A.	Free Air Delivery
	4-30241	310	24	0.18	53	1.40	600
	4-30243	310	24	0.25	53	1.10	600=
	4-40241	410	24	0.18	55	1.40	1450
	4-40243	410	24	0.25	55	1.10	1450
	4-50161	510	16	0.15	56	1.50	1550
	4-50163	510	16	0.18	56	1.65	1550
	4-50241	510	24	0.55	62	3.30	2450
	4-50243	510	24	0.55	62	1.35	2450
	4-60161	610	16	0.37	60	3.30	3200
	4-60163	610	16	0.37	60	1.35	3200
	4-60241	610	24	1.10	69	6.90	4400
	4-60243	610	24	1.10	69	3.30	4400
	4-80123	810	12	0.55	59	2.30	5600
	4-80163	810	16	1.10	64	3.40	7000
	4-10123	1010	12	1.50	65	5.50	10800
	4-12123	1220	12	2.20	70	6.10	15000
	4-15123	1525	12	3.00	76	8.20	20000
	4-15093	1525	09	2.70	72	7.50	20000
	4-18083	1830	08	4.50	74	9.00	30000

Note: Last digit of Model Number denotes electrical supply
1 240/1/50
3 415/3/50

Noise level is indicative and should only be used to indicate relative values as actual figures depend on the fan and relevant field conditions

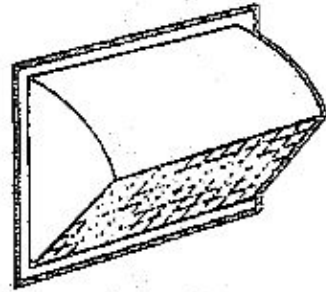
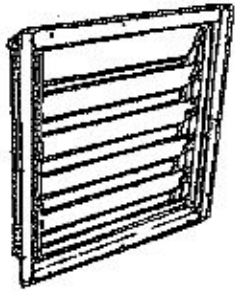

To suit Fan Dia. mm	Dimensions mm	Model No.
310	360 x 360	14-4011
410	460 x 460	14-4012
510	560 x 560	14-4013
610	660 x 660	14-4014
810	810 x 810	14-4015
1020	1020 x 1020	14-4016
1220	1220 x 1220	14-4017
1525	1525 x 1525	14-4018

To suit Fan Dia. mm	Dimensions mm	Model No.
310	360 x 360	14-6330
410	460 x 460	14-6430
510	560 x 560	14-6530
610	660 x 660	14-6630
810	830 x 830	14-6830
1010	1030 x 1030	14-6103

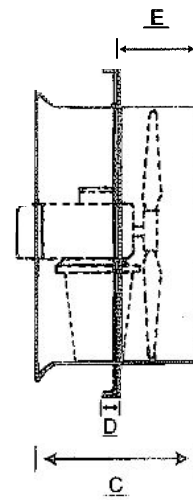
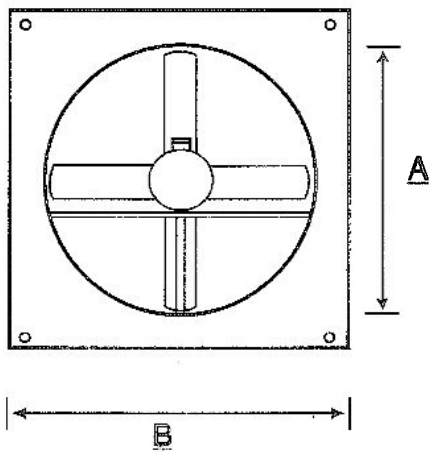

Fan Diameter mm	A mm	B mm	C mm	D (max) mm	E mm	Approx Weight mm
310	316	400	350	25	175	16
410	416	500	350	25	175	22
510	516	600	350	25	175	28
610	618	750	350	25	175	35
810	818	950	400	25	200	60
1010	1020	1150	400	30	200	106
1220	1230	1350	450	30	225	128
1525	1536	1650	450	40	225	165
1830	1970	1840	610	40	305	210



Wall Plate Exhaust Fans

General Description

Fanquip Wall Plate Exhaust Fans are designed and manufactured in Australia to operate in the wide ranging climatic conditions found contrywide. The standard size range goes from a 300mm (0.18kW) right up to the 1830mm (11kW). Special desings are available for Wall Plate Fans up to 2.8 meters in diameter. The fans feature a fully welded rolled stell casing with an inlet flar and outlet spigot. Totally enclosed motors (IP55) offer superior dust and water protection. The adjustable pitch impeller assembly has non-sparking GRP blades with a zinc enriched primer and a heavy duty industrial enamel topcoat.

Spares/Options/Ancillary Products

A full range of spares are available at all times. Options include inlet/outlet guarding to Australian Standards and Hoseproof (IP55), Flameproof (Ex (e), Ex (d)) or 2-spped motors. Casing can be fabricated from Aluminium, Stainless Steel or hot-Dip Galvanised Stell. Louvres and Cowls available as per drawing on page 4.

Applications

Extensive range of applications in factores, plant rooms, workshops, processing plants and machinery. Used for extraction of heat, steam, dust, stale air and fumes.

Technical Advice

Industrial Fan Equipment Pty Ltd (Fanquip) has technical consultants available to give advice on the correct choice of Wall Plate Exhaust Fans for your needs.

Installation and Maitenance

The procedures as outlined in Fanquip installation, operation and maintenance instructions (separate leaflet), should be followed to ensure satisfactory performance and service life.

Warranty

Twelve months guarantee on mechanical and electrical componentry subject to satisfactory maintenance with assessment and rectification, if any, to take place after return by customer to Fanquip's workshop.

